



QuickBreak QDB series (ISO 7241-1 Series B) Coupler and Nipple

These premium branded quick connect fittings are interchangeable with Hansen, Parker, Rectus and Faster fittings.

Available in:

- Brass
- Plated Steel
- 303 & 316 Stainless Steel

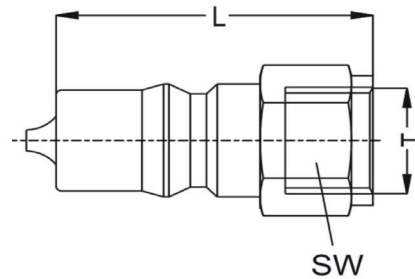
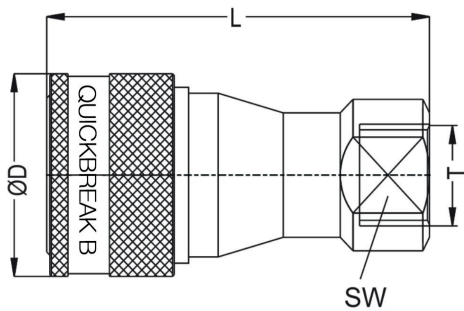

ØT Connection	SW (mm)	ØD (mm)	L (mm)
1/8"	14	25	49
1/4"	19	29	58
3/8"	24	35	64
1/2"	29	44	74
3/4"	36	53	94
1"	41	60	106

ØT Connection	SW (mm)	L (mm)
1/8"	14	30
1/4"	19	35
3/8"	24	39
1/2"	29	46
3/4"	36	60
1"	41	65

*Available in BSPP or NPTF

QuickBreak ISO B Working Pressures

QuickBreak ISO B Working Temperatures

Body Size (Inches)	Brass (Bar)	Plated Steel (Bar)	Stainless Steel 303/316 (Bar)
1/8"	210	300	300
1/4"	185	300	300
3/8"	152	280	280
1/2"	160	280	280
3/4"	138	250	250
1"	105	230	230

Seal	Temperature Range	
	°C	°F
NBR (Nitrile)	-20°C + 110°C	-4°F + 230°F
FMK (Viton)	-20°C + 180°C	-4°F + 356°F
EPDM	-40°C + 150°C	-40°F + 302°F
CR	-40°C + 100°C	-40°F + 212°F